

SPECIFICATIONS:

POWER RATING: 25 WATTS CW

- WHEN MOUNTED TO A HEAT SINK
CAPABLE OF MAINTAINING A CASE
TEMPERATURE AT OR BELOW 100°C.

FREQUENCY RANGE: DC TO 3 GHz

VSWR: DC TO 1 GHz AT 1.15:1 MAX.

1 GHz TO 3 GHz AT 1.25:1 MAX.

CONNECTOR: SMA FEMALE

FINISH: BODY: SILVER OR TRI-ALLOY PLATED

CONNECTOR: GOLD PLATED

RESISTIVE ELEMENT: BeO SUBSTRATE, SILVER THICK FILM

REVISIONS		DWG. NO.	25-CT-FA	SHEET	REV
ZONE	REV	DESCRIPTION	DATE	1	B
	A	CONVERT TO BEC FORMAT	DMR	6-21-04	MRV
	B	SHOW RESISTIVE ELEMENT MATERIAL/ECO 12247	DMR	8-4-04	MRV

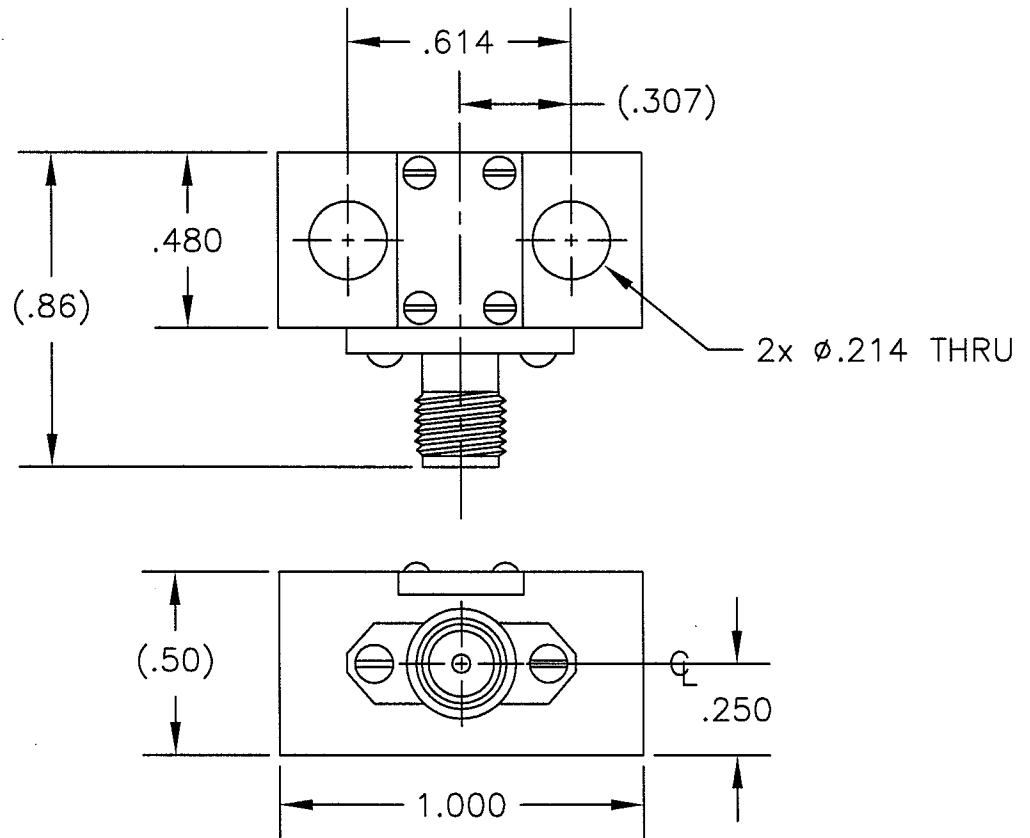

UNLESS OTHERWISE SPECIFIED
DIMENSIONS ARE IN INCHES
TOLERANCES ARE:

FRACTIONS DECIMALS ANGLES
± 1/64 .XX=±.010 ± 30'
.XXX=±.005

DO NOT SCALE DRAWING

MILLIMETERS

.X=±.4
.XX=±.12

THIS DRAWING IS THE PROPERTY OF THE BIRD ELECTRONIC CORPORATION. THE DESIGNS AND SPECIFICATIONS DISCLOSED HEREON ARE PROPRIETARY AND SHALL NOT BE REPRODUCED, NOR COPIED, NOR USED AS THE BASIS FOR THE MANUFACTURE OR SALE OF APPARATUS OR DEVICES WITHOUT THEIR EXPRESS WRITTEN CONSENT.



BIRD

Electronic Corporation
Cleveland (Solon) Ohio USA

MATERIAL	APPROVALS	DATE	TITLE		
	D.M.RINK	6-21-04	TERMINATION, CONDUCTION COOLED SMA FEMALE, 25W		
	CHECKED		SIZE	FSCM NO.	DWG. NO.
			A	70998	25-CT-FA
	APPROVED	6-21-04	SCALE	COMM CODE	SHEET
	MARK V.		1:1	LD1	1 OF 1
		AUTOCAD			

FINISH	REV
	B